

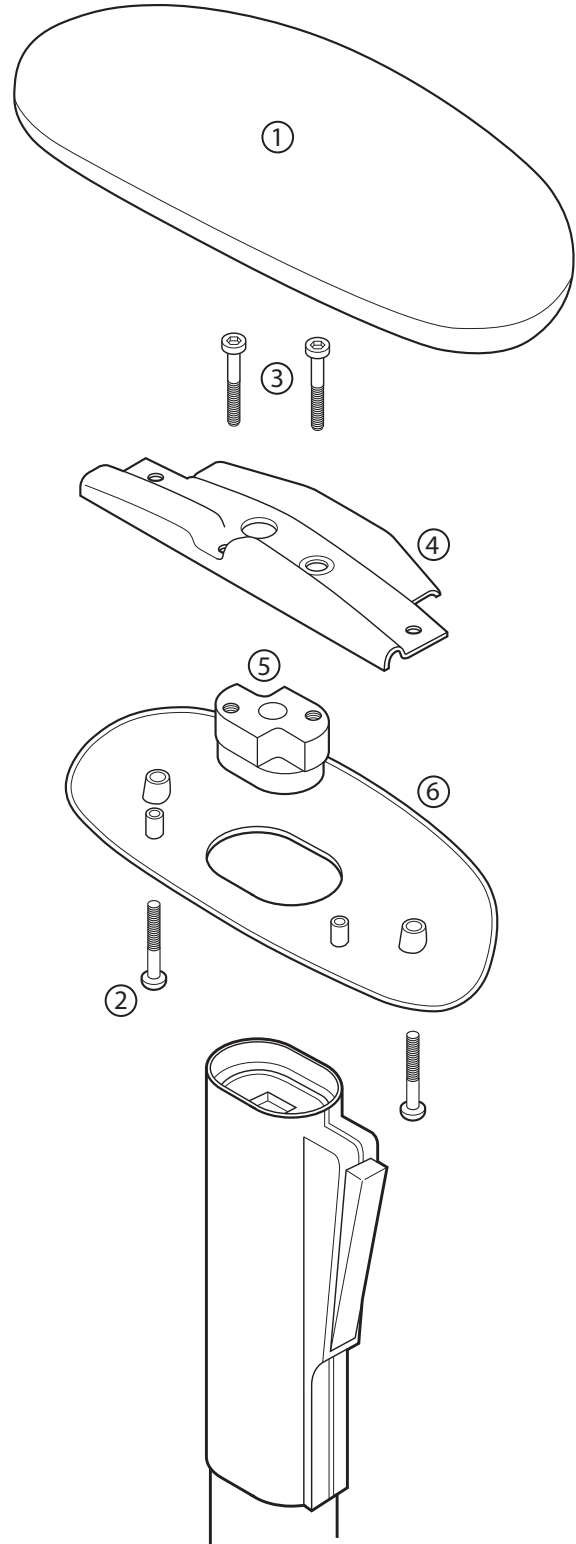

Criterion Lower Armpad Cap

- 1) Remove the screws (2) located underneath the armpad (1) and lift the armpad off.
- 2) Remove the second set of screws (3). You will need a Torx T-25 bit for these screws.
- 3) Remove the steel bracket (4), and plastic bushing (5), then remove the old cap (6).
- 4) Place the new lower armpad cap (6) on top of the arm and position the plastic bushing (5).
- 5) Align the steel plate over holes in the plastic bushing (5). Replace the two T-25 screws (3).
- 6) Place armpad over the steel plate and replace the two small Phillips head screws.



Old "half moon" style armpad

